

OWNER'S MANUAL

COMMERCIAL SERIES



IMPORTANT SAFETY INSTRUCTIONS

When using an electronic appliance, basic safety precautions should always be followed. Read all guidelines before operating the unit.

To reduce risk of fire, electric discharges or injuries:

- Use this vacuum only for its intended use as described in this manual. (Use of attachments not recommended by the manufacturer may cause fire, electric shock, injury or damage to system components.)
- Do not allow vacuum to be used as a toy. Close supervision is necessary when this vacuum is used by or near children.
- Do not leave the unit running without any supervising. Disconnect the unit if it is not used and before maintenance.
- Do not pick up anything that is burning or smoking, such as cigarettes, matches, or hot ashes.
- This vacuum cleaner is intended for dry pick up only. Do not use on wet or humid surfaces, waste solvents (paint or other), explosive materials that would cause harm to the vacuum cleaner.
- Do not vacuum drywall dust or baking flour as it may cause damage to your vacuum.
- Avoid picking up hard or sharp objects to prevent damaging or block the hose and the plastic pipes.
- Do not put any object into openings. Do not use if an opening is blocked. Keep free of dust, lint, hair and anything that may reduce airflow/suction. Lack of air flow will cause the motor to overheat.
- This vacuum cleaner creates suction. Keep hair, face, fingers, all body parts and loose clothing away from any openings.
- Never operate without dust bag and/or filter in place.
- Never plug in a unit designed to operate with a current of 120V in a 230V outlet and vice versa.
- If the power cord is damaged, it must be replaced by a special cord available from the authorized local dealer/distributor.
- Do not use extension cords or outlets with inadequate current carry capacity.
- Never operate this vacuum if it has a damaged cord or plug, if it is not working properly, or if it has been dropped or damaged. Return to authorized dealers/distributor for repairs.
- Never handle plug, cord or power units with wet hands.

- Never disconnect plug by pulling cord. To disconnect from the outlet, grasp the plug, not the cord.
- Connect to a properly grounded outlet only. See grounding instructions.
- Keep cord away from heated surfaces.
- Turn off all controls before unplugging.
- Hoses with electrical connections must not be used if damaged.

By overlooking safety rules, you might risk putting your health in danger and to those who surround you!

Drainvac disclaims any responsibility should you infringe upon these guidelines.

SAVE THESE INSTRUCTIONS

The commercial series' models
do not comply with NFPA standards.



TECHNICAL SPECIFICATIONS

REGISTRATION.....	6
TECHNICAL SPECIFICATIONS	7
UNIT DESCRIPTION.....	8
HOUR METER / DUST BAGS AND FILTERS	9

UNIT INSTALLATION

FIRST THINGS FIRST.....	10-11
MOUNTING THE UNIT ON THE WALL.....	12-13
CONNECTING THE AIR INLET	13
DUST BAG.....	14
AUDIOPROTEK MUFFLER / MUFFLER.....	15

PIPING INSTALLATION

GENERAL NOTICE	16
DIFFERENT INSTALLATION POSSIBILITIES	17
EXAMPLES OF PROPER AND IMPROPER INSTALLATIONS	18-20

ELECTRICAL POWER SUPPLY

CONNECTION PROCEDURES	21
EXAMPLES OF PROPER AND IMPROPER INSTALLATIONS	21
DIAGRAM OF AN APPROPRIATE CONNECTION	22
GROUNDING INSTRUCTIONS.....	23

MAINTENANCE PROCEDURES..... 24

WEEE GUIDELINES / ROHS / SUPPORT..... 25

TECHNICAL PROBLEMS 26

ANNEX

ANNEXE I (CIRC18)
ANNEXE II (CIRC03)

INTRODUCTION

We wish to thank you for your trust and congratulate you for having chosen a Drainvac product. It is a sound investment that will satisfy your vacuuming needs for years to come. Drainvac's central vacuum cleaners are manufactured and checked at our factory by our qualified staff who have been specifically trained to this end. A number of installations and operating methods must be followed to ensure your system's maximum performance and to avoid unnecessary service calls. Please read this manual carefully.

REGISTRATION

To fill in the Drainvac product registration form, go to www.drainvac.com/client-support/register-your-drainvac

First off, we recommend you to fill out this form before you start the installation process. If you have any concerns or problems you may encounter, please contact the nearest retailer. The unit's profile will be required.

C 228571	AMPS	VOLTS	CYCLE	WATTS	NO SÉRIE 0000000	
	11	120	60Hz	2314		
DATE		MODELE				
11/05/2017		DV2A310				
DRAINVAC INTERNATIONAL 2008 INC. WWW.DRAINVAC.COM						
ATTENTION - WARNING - ADVERTENCIA						
NE PAS BLOQUER LA VENTILATION NE RIEN PLACER SUR LE CAPOT DE L'APPAREIL RISQUE D'ELECTROCUTION, DÉBRANCHER L'UNITÉ AVANT TOUTE MAINTENANCE POUR RÉDUIRE LE RISQUE DE CHOC ÉLECTRIQUE, NE PAS ASPIRER DE DÉCHETS HUMIDES						
DO NOT BLOCK VENTILATION DO NOT PUT OBJECTS ON TOP OF THE APPLIANCE RISK OF ELECTRIC SHOCK, DISCONNECT POWER BEFORE SERVICING UNIT TO REDUCE THE RISK OF ELECTRIC SHOCK, DO NOT USE ON WET SURFACES						
NO OBSTRUYA LA VENTILACION NO PONGA NADA ENCIMA DEL APARATO RIESGO DE CHOQUE ELÉCTRICO, DESCONEXE LA UNIDAD ANTES DEL MANTENIMIENTO PARA REDUCIR EL RIESGO DE DESCARGA ELÉCTRICA, NO UTILICE EN SUPERFICIES MOJADAS						
Fabriqué au Canada - Made in Canada - Hecho en Canadá						

Metal tag

Model*: _____

Serial number*: _____

Retailer name: _____

Date of purchase: _____

Date of the last maintenance: _____

You have purchased one of the following models. Identify the one to related to it.

The model number appears on the technical label stuck on the left side of the unit.



MODELS	HP	H ₂ O	CFM	DECIBELS	AMPS	CAPACITY	SIZE in / cm
2AC9922-CT	2.34	160	105	63	14.5 (108V - 120V)	9 gal. / 41 L	15 dia. x 28 / 38 dia. x 70
2AC9932-CT	4	170	135	69	13 (220V - 240V)		

*This information is found on a metal tag located on the left side of the unit.

UNIT DESCRIPTION

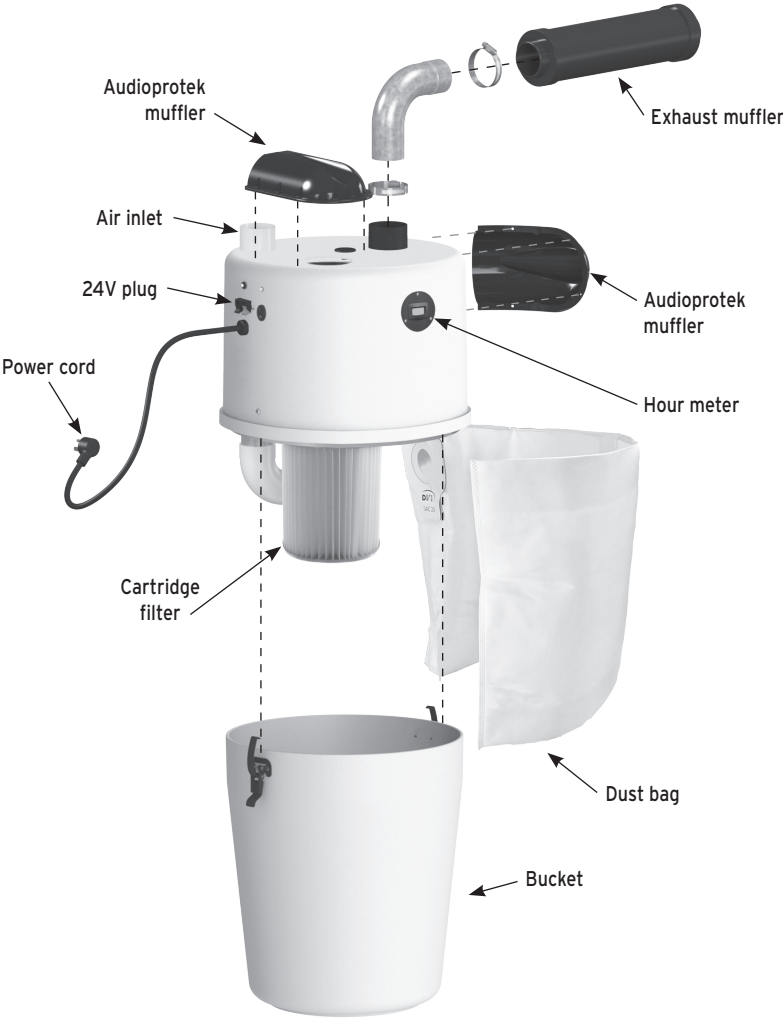

HOUR METER

The commercial models are equipped with an hour meter that indicates the length of time the unit has been running. When the unit reaches the 500-hour mark, it is strongly recommended to contact your Drainvac representative or retailer for maintenance purposes.



DUST BAGS AND FILTER

Every model of the commercial series is designed to operate with a dust bag and a cartridge filter. Improper use will void the warranty.



SAC14
Disposable 2-ply paper
dust bags, 9 gal. (41 L)



SAC20
Disposable 3-ply cloth
dust bags, 9 gal. (41 L)



FILT25
Cartridge filter

REQUIRED TOOLS



5/16" Socket
Head Screwdriver



Phillips Screwdriver

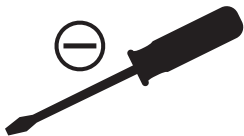

Regular Screwdriver

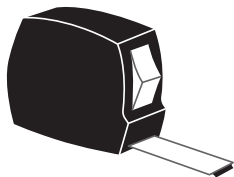

Measuring Tape

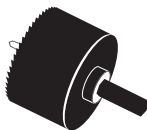

Hole Saw
2.25" (57 mm)



Cutting Pliers

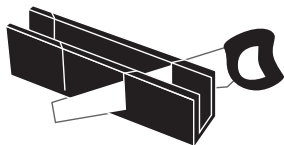

Mitre-Box and Saw



or

PVC Pipe Cutter
2" (50 mm)



Drill
0.5" (12.5 mm) bit

WHERE TO INSTALL THE UNIT

We recommend installing the system on the **lowest level of the building** to avoid having to work against gravity. Dust and solids will fall easier than being pulled upwards, this is why the basement is generally the most ideal location. If there is no basement, a storage room is equally suitable.

MINIMUM DIMENSIONS AND SPACING

It is important to install the unit in a location where it will be easily accessible for maintenance and to effectively evacuate dust. The minimum spacing required is the following:

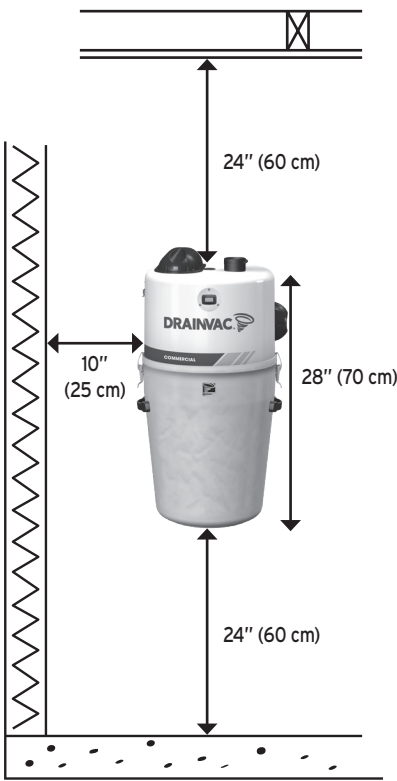

UNIT INSTALLATION

1) MOUNTING THE UNIT ON THE WALL

- Undo the fastener securing the wall bracket and base at the back of the unit with cutting pliers.

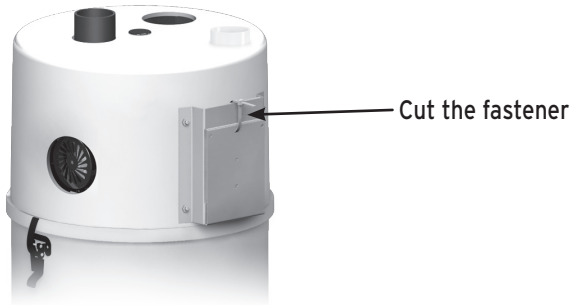

If the wall is covered with gypsum board, we recommend installing a wooden panel screwed to the wall studs beforehand for more stability. Then, screw the bracket to the wall with the five (5) screws supplied with the unit.

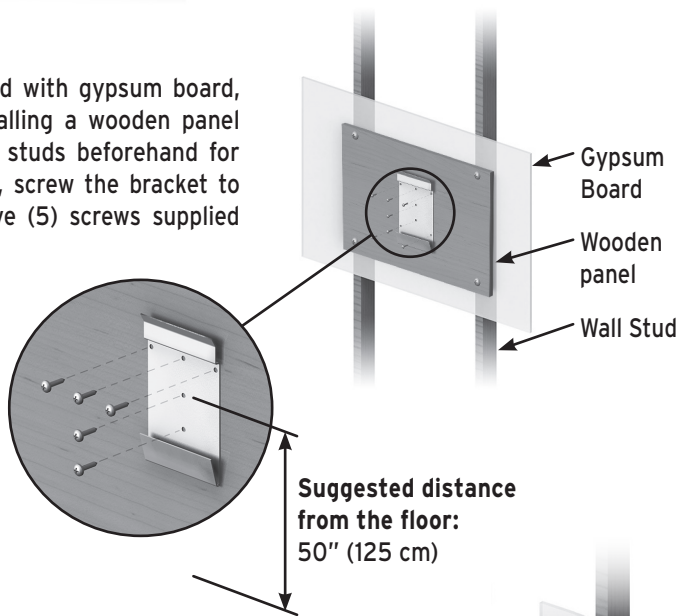

For a installation directly on a wall stud, screw three (3) screws in the middle area only.



UNIT INSTALLATION

- Lift the head to slide its support onto the wall bracket.

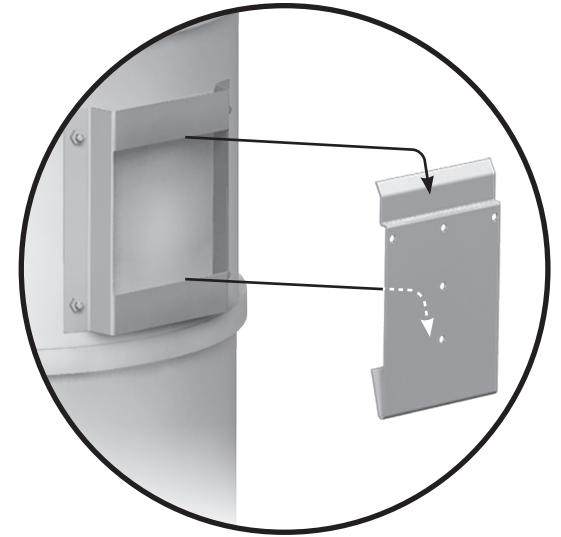

2) CONNECTING THE DUST INLET

- Connect the dust inlet onto the unit securing it with a collar (do not glue).



3) DUST BAG

- Install the appropriate dust bag for your model and follow the instructions printed on the back of the packaging.

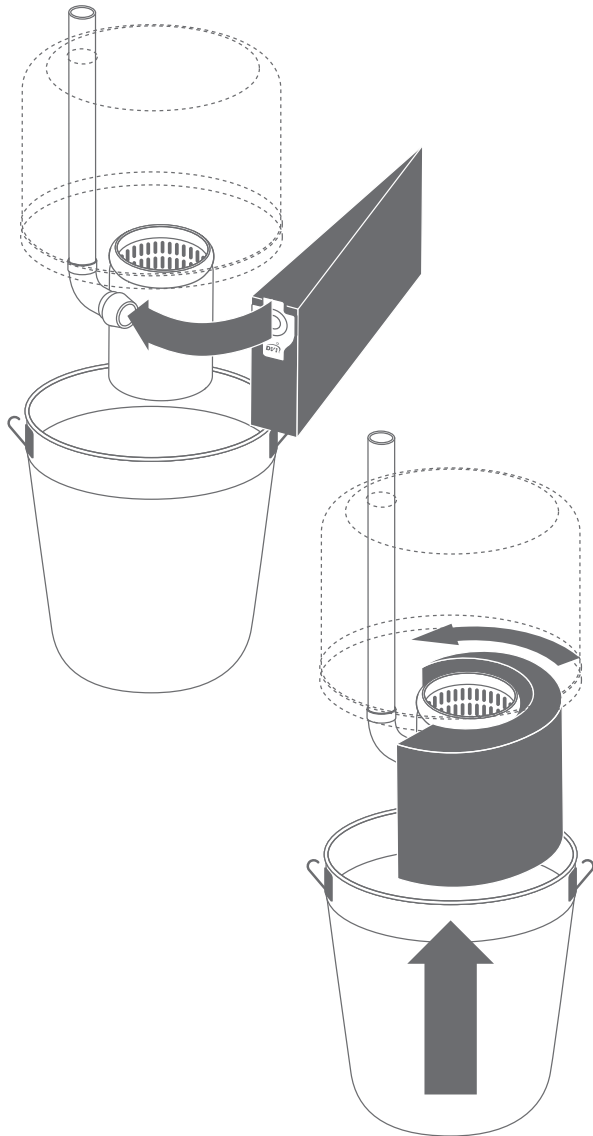

4) AUDIOPROTEK MUFFLER

Your unit is supplied with audioprotek mufflers.

- Peel the plastic strip from the foam and stick the mvuffler onto the unit's head. The straight muffler goes on top, and the curved one on the side.



5) MUFFLER

- Connect the air outlet to the unit by securing everything into place with ring clamps (do not glue). If needed, the 90° elbow can be replaced by a straight pipe.



PIPING INSTALLATION

The following pages illustrate piping diagrams, typical installations and the parts that we recommend for an optimum performance of your central vacuum system.

GENERAL INFORMATION

- **An air outlet leading outside must always be installed on a two-motor unit. Make sure that the evacuated air does not lead under a carport.**
- If your unit includes two motors, it is important to use metal piping and couplings for the air outlet.
- To determine where to locate the wall inlets, use the length of the vacuum hose as a basis, measuring the furthest point from the wall where the wall inlets are to be installed. Do the same for all the wall inlets until all areas of the house or building can be reached with the vacuum hose, by moving it from one wall inlet to another.
- If your walls are made of gypsum board, **never install a wall inlet in the centre of the wall.** Drill the holes for the wall inlets close to a wall stud or a door frame.
- Any screw length can be used if you install the piping as illustrated in **Figure A**.
- If you install the piping as illustrated in **Figure B**, make sure to position the small screw in the right place to avoid piercing a hole through the pipe.
- Always use a short elbow when connecting the wall inlets (**Figures A and B**) to prevent long objects (for example, a pencil) that may have been vacuumed by mistake from blocking the piping further on.

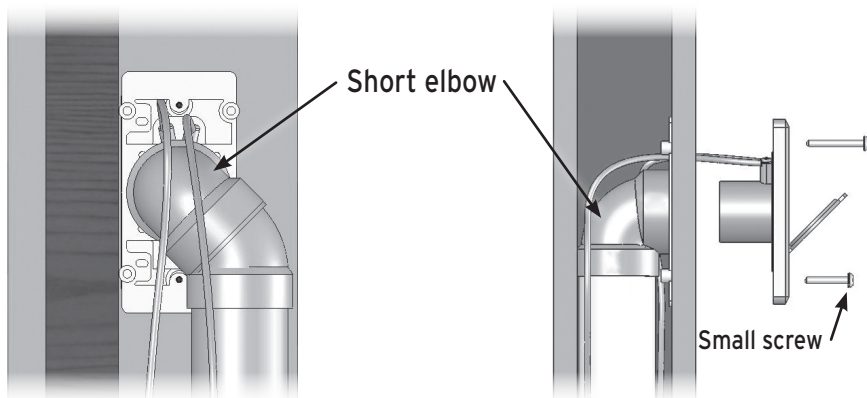

Figure A

Figure B

PIPING INSTALLATION

DIFFERENT INSTALLATION POSSIBILITIES



On the top floor
(at the end of a pipeline)



On an intermediary floor

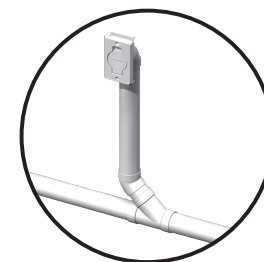

On the first floor
(connected above a pipeline
under the floor)



In the basement
(connected under a pipeline
under the floor)

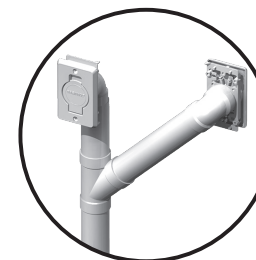

Back-to-back

EXAMPLES OF PROPER
AND IMPROPER INSTALLATIONS

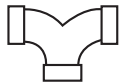

Thin wall
Thick wall
For wall plates only

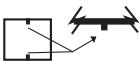
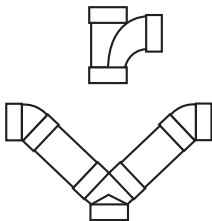

Joint with inside stoppers

Smooth joint without
inside stoppers

EXAMPLES OF PROPER
AND IMPROPER INSTALLATIONS

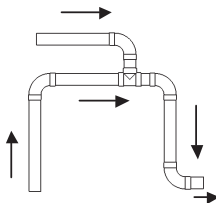
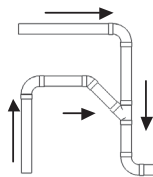
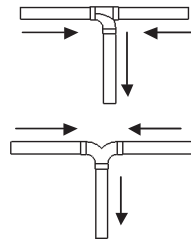
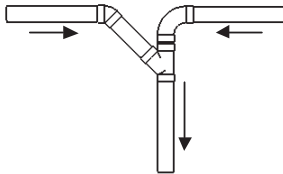
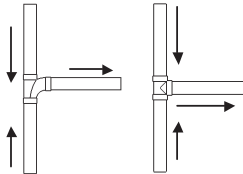
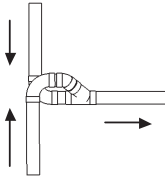
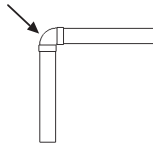
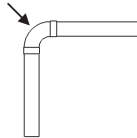
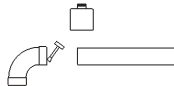
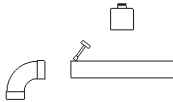

PIPING INSTALLATION

EXAMPLES OF PROPER AND IMPROPER INSTALLATIONS

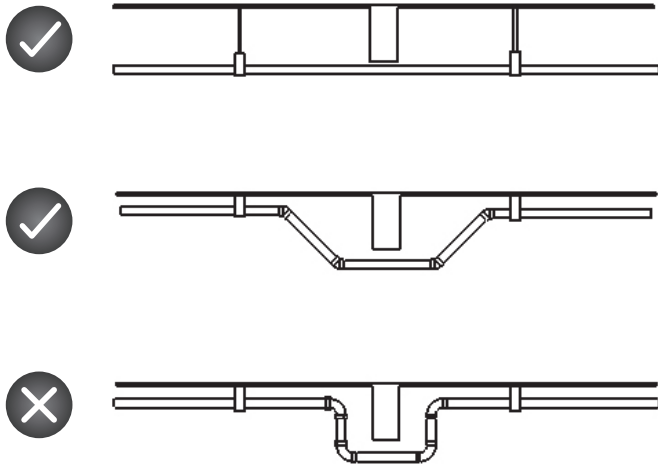
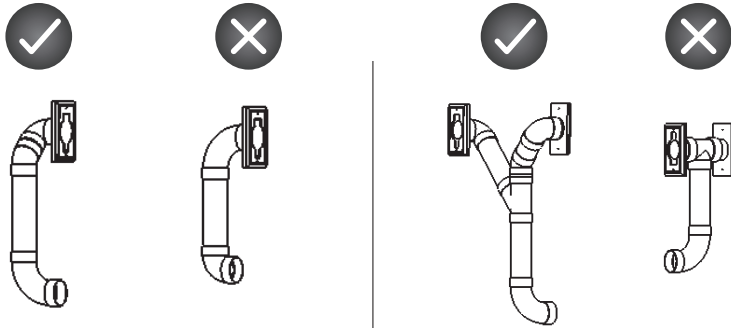

ELECTRICAL POWER SUPPLY

An electrical cord is equipped to all central vacuum systems. An adequate electrical power outlet must be installed near the unit. **We strongly recommend installing an electrical circuit which will be used only for the unit.**

CONNECTION PROCEDURE

- Install the 24-volt wires from the network (each wall inlet) to the unit.
- Connect the unit to the electrical outlet with the power-supply cord.
- The unit is now ready to be used.

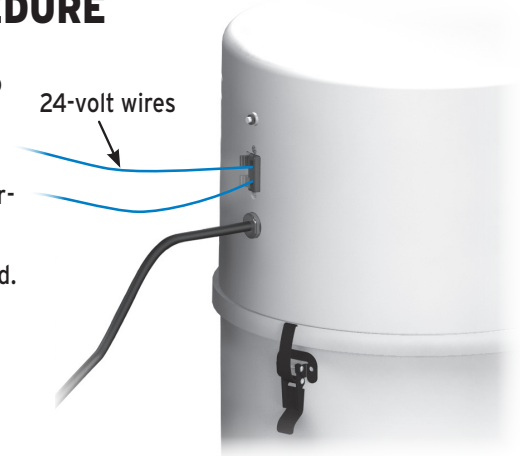

EXAMPLES OF PROPER AND IMPROPER INSTALLATIONS

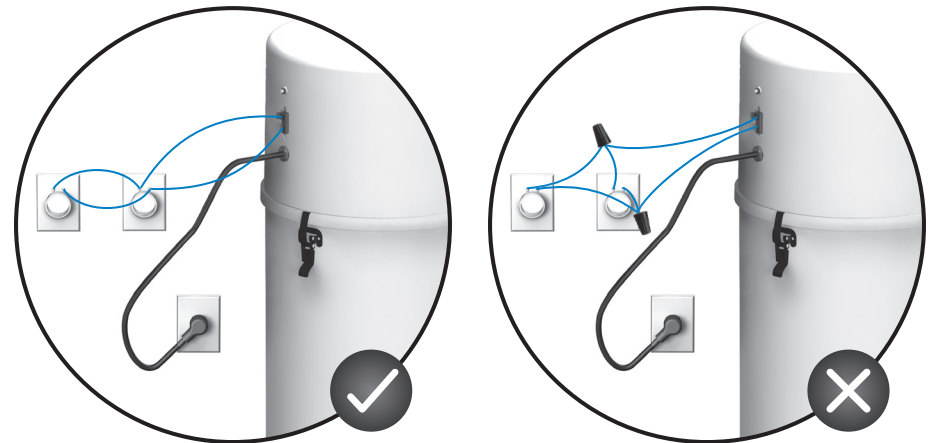
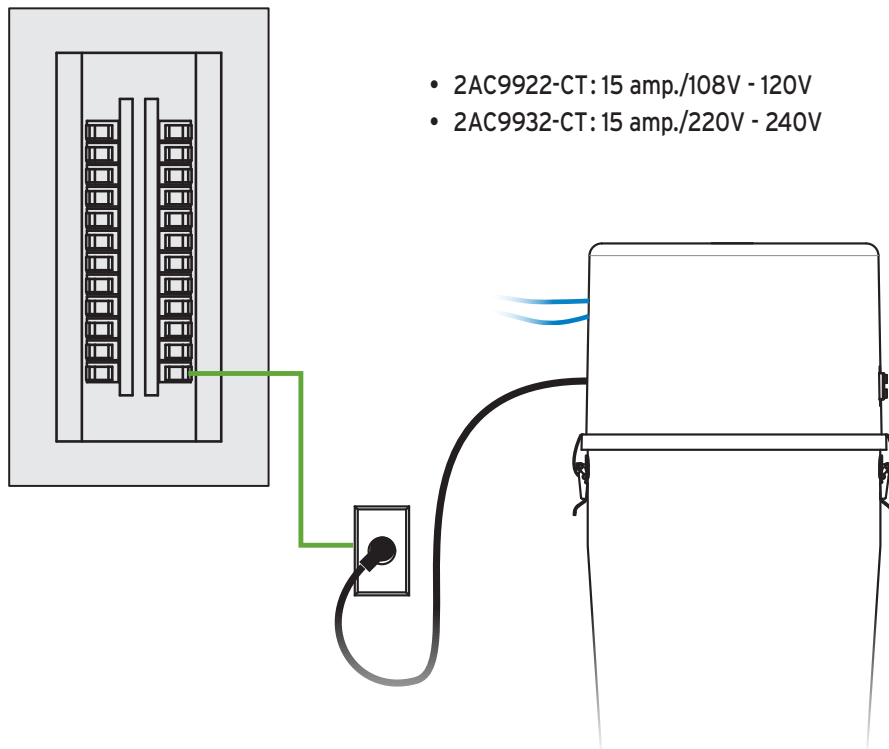

DIAGRAM OF AN APPROPRIATE CONNECTION

The electric installation must be compliant to the building code in effect of your state or country. If you experience voltage surge problems on your electrical circuit in spite of adequate connections, a high magnetic circuit breaker can be installed on your electrical panel. Contact an electrician for more information.

Electrical panel



GROUNDING INSTRUCTIONS

These units must be grounded. If it should malfunction or breakdown, grounding provides a path of least resistance for electric current to reduce the risk of electric shock. This appliance is equipped with a cord having an equipment-grounding conductor and grounding plug. The plug must be inserted into an appropriate outlet that is properly installed and grounded in accordance with all local codes and ordinances.

WARNING - Improper connection of the equipment-grounding conductor can result in a risk of electric shock. Check with a qualified electrician or service person if you are in doubt as to whether the outlet is properly grounded.

**DO NOT MODIFY THE PLUG PROVIDED WITH THE UNITS -
IF IT DOES NOT FIT THE OUTLET, HAVE A PROPER OUTLET INSTALLED
BY A QUALIFIED ELECTRICIAN.**

These units are for use on a nominal 120V or a 230V circuit and have a grounding attachment plug that looks like the one illustrated below. Make sure that the electrical cord is connected to an outlet having the same configuration as the plug.

NO ADAPTOR SHOULD BE USED WITH THIS APPLIANCE.

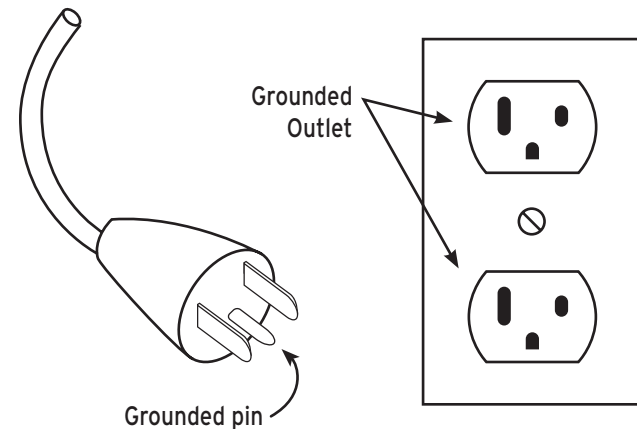

*Illustration of a north-american electrical outlet

MAINTENANCE PROCEDURES

Each system requires a minimum maintenance, without any exception.

MOTOR BRUSHES

Beyond the occasional external cleaning, we recommend that you **inspect your motor brushes after 500 hours of use** to check how worn they are and have them replaced if necessary. On average, this inspection should occur once every 3 to 5 years. When the time comes, contact your retailer or distributor for this maintenance procedure. Take note that the motor brushes are not included in the warranty.

CARTRIDGE FILTER AND DUST BAG

You must clean the cartridge filter and replace the dust bag periodically. This will prevent your vacuum from losing any power and will extend its lifespan.

- The dust bag **CANNOT** be washed or emptied. It must be replaced by a new one. If you notice a flagrant decline of power, it may be a sign of a full dust bag and must be changed. **DO NOT CHANGE THE DUST BAG WHILE THE UNIT IS RUNNING.**
- The cartridge filter can be air cleaned or water cleaned periodically, but must be replaced every 3 years. If water cleaned, it must be **COMPLETELY DRY** before reusing.

Here is how to procede:

1. Release the clamps between the main unit and the tank.
2. Remove the bag and discard it (if you must).
3. Clean or wash the filter and let it dry.
4. Place the filter.
5. Place the new dust bag.
6. Reattach the tank to the main unit.

***IF THE UNIT IS USED EITHER WITHOUT THE FILTER OR THE DUST BAG,
THE WARRANTY WILL BE VOIDED.**

WEEE GUIDELINES

This unit complies with the **WEEE (Waste Electrical and Electronic Equipment) Guidelines**, which promote the recycling of this type of waste equipment and encourage the development of products that are adapted to efficient waste reclamation at the end of their life cycle.

The WEEE Guidelines stipulate that the original supplier should agree to reclaim any obsolete equipment free of charge. We recommend that you advise your supplier that you would like him to reclaim your unit when you order and replace it with a new one.

Do not discard the unit with your regular garbage. The symbol representing a garbage bin on wheels on the unit's label (**Figure C**) attests to this requirement. You must ensure that, at the end of its life cycle, your unit is reclaimed, treated and recycled by an authorized retailer or firm.

For more information, contact your municipal waste management department.

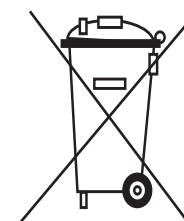

Figure C

RoHS

All presented units respect the European directive RoHS which limits the usage of six dangerous substances.

SUPPORT

If you wish to speak with a customer service representative, please contact your supplier/dealer.

To find a retailer near you, please visit our website.

TECHNICAL PROBLEMS

THE UNIT WON'T START UP...

SOLUTION:

- 1) Check if the LED is lit.
- 2) Check the circuit breaker in your electrical panel.
- 3) Check the unit's circuit fuse/breaker.
- 4) Check the 24-volt circuit, as follows:

Establish an electrical contact between the two 24V circuit terminals of the unit with a metal object such as a screwdriver or a coin.

- If the unit starts up, either the 24V wire is cut or disconnected from one of the wall inlets, or the hose is defective.
- If the unit does not start up after all these steps, the printed circuit is defective.

THE UNIT WON'T SHUT DOWN...

SOLUTION:

Check the 24-volt circuit as follows:

Disconnect one of the two wires on the unit's 24-volt circuit.

- If the unit shuts down, the problem could be that two 24-volt wires are touching themselves somewhere or that the wall inlet is defective.
- If the unit doesn't shut down, the printed circuit is defective.
Unplug the power cord.

Drainvac International

150 Brunet Street, Mont-St-Hilaire, QC J3H 0M6, Canada

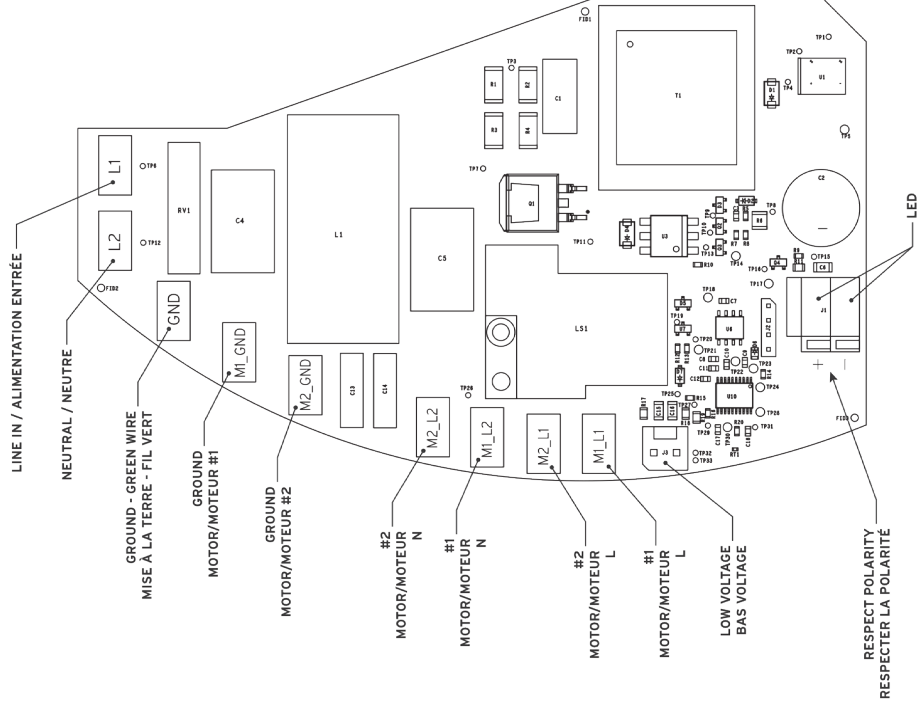

ANNEXE I
CIRC03
DIAGRAMME DE CONNEXIONS
220-240 VOLTS
2AC9932-CT

ANNEX I
CIRC03
CONNECTION DIAGRAM
220-240 VOLTS
2AC9932-CT

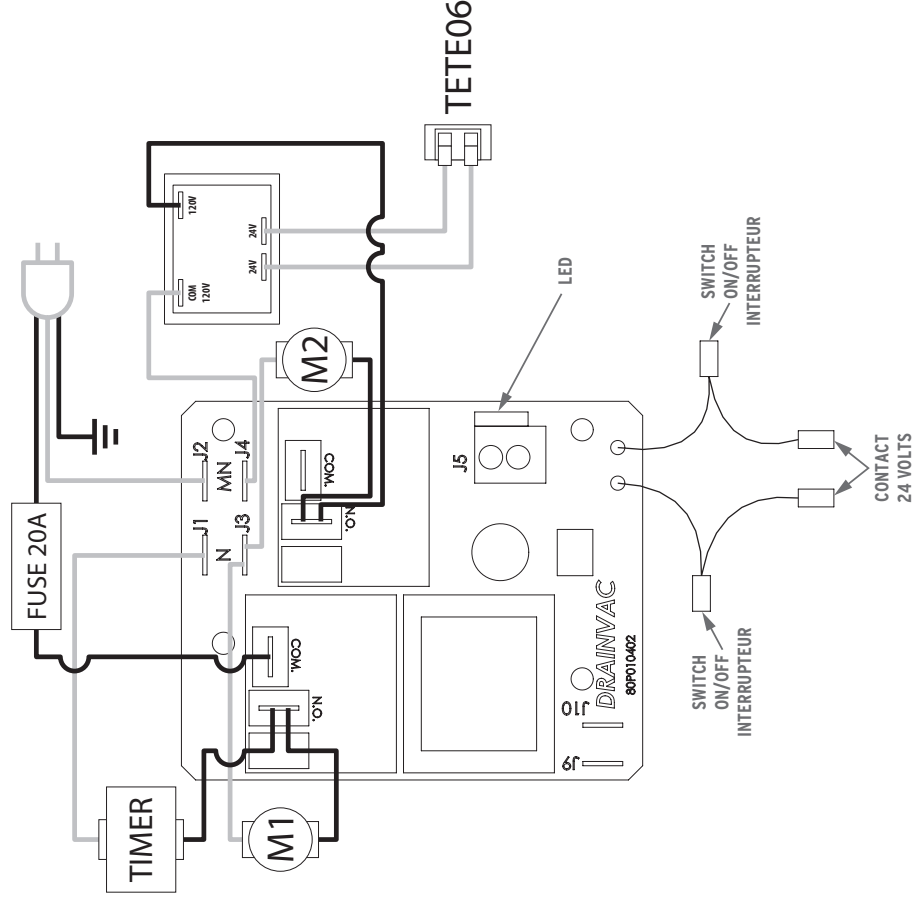

ANNEXE II
CIRC03
DIAGRAMME DE CONNEXIONS
110-120 VOLTS
2AC9922-CT

ANNEX II
CIRC03
CONNECTION DIAGRAM
110-120 VOLTS
2AC9922-CT